

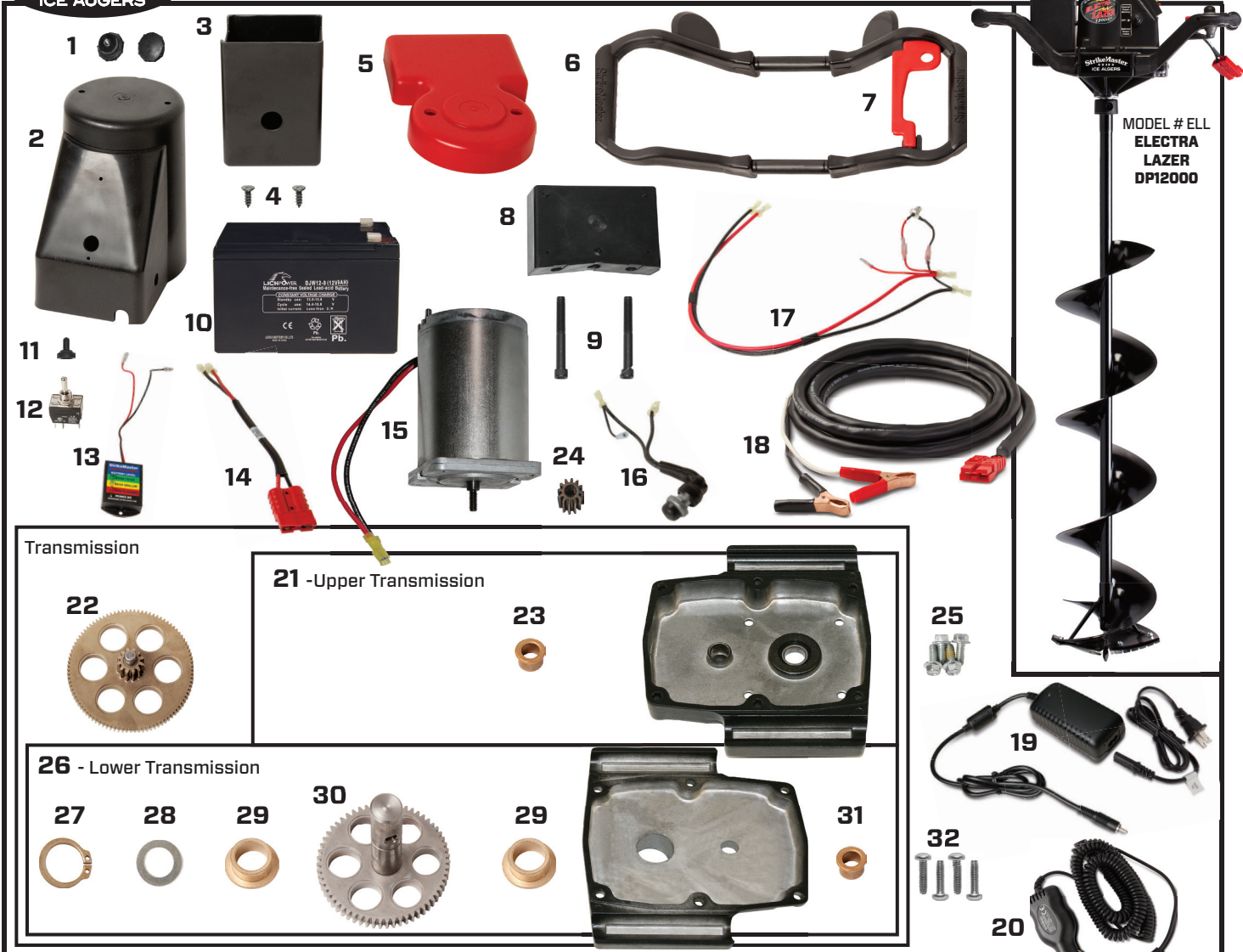

# ELL - ELECTRA LAZER DP12000 2009-2012 Parts List



MODEL # ELL  
ELECTRA  
LAZER  
DP12000

#	Part No.	Description
1	151322	Battery Cover Knobs (2 Per Pack)
2	151348	Electra Motor Cover
3	151312	Battery Box
4	410030	Battery Box Screws
5	151319	Motor/Battery Box
6	151388C-A	Composite Handle with Lever (Includes #7)
7	151645E	Throttle Lever with Screw
8	151321-09	Battery Mounting Bracket (No Longer Available)
9	151338	5/16-18 x 3 SHCS Bracket Bolt (No Longer Available)
10	ERB-1	12-volt/9-amp Battery Replacement
11	151318	Toggle Switch Boot
12	151317	Internal/External Toggle Switch
13	151310-09	Battery Meter
14	151320-09	Power Pole Assembly
15	151438	ELL Motor
16	151336-09	60-amp Push Button Switch Assembly
17	151315-09	DC Power Assembly with Charger Plug
18	151358	Power Cord with Battery Clamps
19	EBC-1	12-volt Battery Charger Plug-in (Wall Outlet Adapter)
20	ECC-2	1.0-amp Car Charger Plug-in (No Longer Available)

#	Part No.	Description
		Transmission
21	211T-U	Upper Transmission (Includes #23) (Replaced by 140S-U)
22	211310	40:1 Compound Gear
23	122210	Flange Bushing Compound (Upper)
24	140320	40:1 Pinion Gear (No Longer Available)
25	470833	Upper Transmission Bolt - 1/4 - 20 x 5/8 HHFLGBLT with Nylon Patch (Requires 4)
26	211T-L	Lower Transmission (Includes #27, 28, 30, 31 & qty 2 - 29) (Replaced by 140S-L)
27	122920	Snap Ring Output Shaft
28	122915	Output Shaft Washer
29	122215	Flange Bushing Output Shaft (Requires 2)
30	122305	Output Shaft with Drive Gear
31	122210	Flange Bushing Compound (Lower)
32	410011A	Lower Trans Screws Self Tap Philips (No Longer Available)